



east

東隅 HONG KONG



EAST, HONG KONG

A LIFESTYLE HOTEL INSPIRED BY YOU

When you need to get things done, EAST is plugged in for business.
When it's time to unwind or recharge,
you'll find the perfect uncluttered environment to relax.
Most refreshing of all, our people who are energetic and passionate
about understanding you and whatever you need.

There's no place like EAST.



WHERE THE BUSINESS IS

EAST is located right next to one of Hong Kong's most vibrant business districts, Taikoo Place. Global businesses including Fortune 500s, law firms, financial, media companies, and cultural hotspots make up the neighbourhood. And just across the street, Cityplaza houses 170 leading shops, restaurants and entertainment venues with ample parking spaces.





ARTS

Resin dinosaur in the suites, thousands of orange butterflies fluttering from the lobby to the first floor and abstract paintings in the semi-private dining rooms.

The bold, contemporary collection of artwork is carefully displayed to enlighten all your senses.

ROOMS

SPACE STATION: INNOVATIVE DESIGN
GIVES YOU MORE

Glass screens blend bedroom and
bathroom, creating a seamless space

Earth tone finish creates natural comfort

All rooms feature:

- + Complimentary WiFi
- + Apple TV (available in selected rooms)
- + Mini bar (complimentary in suites)
- + Coffee machine
- + Complimentary tea and infusions
- + Walk-in rain shower
- + In-room safe

Room size:

Urban View – 28 sqm

Urban Corner – 28-30 sqm

Harbour View – 28 sqm

Harbour Corner – 30 sqm

Suite – 44-60 sqm





Whether you prefer a harbour view or a more metropolitan background, all our suites feature king beds, walk-in rain showers, and relaxing bathtubs.

Our suites range from 44 to 60 sqm, and if you look for a little more fun, our signature bubble chairs are also featured exclusively in harbour view suites.





BEAST (Body by EAST)

Open 7 days a week, the 24-hour spacious, naturally-lit gym and a heated outdoor swimming pool will keep you on the move.



FEAST (Food by EAST)

SIMPLE THINGS DONE WELL

FEAST is a café brimming with Asian specialties and international favourites, all prepared with a philosophy of simplicity and quality.

A cake counter is available at the entrance of FEAST.

Complimentary delivery to Cityplaza, One Island East and Taikoo Place can be arranged with a minimum spend. Other locations are subject to an additional transportation cost.

Our team provides catering services, please contact us for details.

Monday to Sunday
6:30am - 11:00pm
T: +852 3968 3777
E: feastreservations@east-hongkong.com

SUGAR

(Bar.Deck.Lounge)

THE SLEEK ROOFTOP BAR
THE CITY LOOKS UP TO

Sitting 300 feet above the harbour, Sugar has one of the best-loved views in town and is a feature on the Hong Kong nightlife scene. A favourite of the Taikoo crowd, the 32nd floor bar's resident DJ, extensive cocktail list, and international tapas are a hit with locals and visitors alike.

Sugar can accommodate private events between 20 to 190 people. Please contact us for details on private bookings.

*Monday to Thursday & Sunday
5:30pm - 1:00am*

*Friday, Saturday & eve of Public Holidays
5:30pm - 1:30am*

*T: +852 3968 3738
E: reservations@sugar-hongkong.com*

Event Inquiries

*T: +852 3968 3383
E: events@east-hongkong.com*



EAST, Hong Kong

29 Taikoo Shing Road, Taikoo Shing, Hong Kong

T : +852 3968 3968

F : +852 3969 3988

E : info@east-hongkong.com

www.east-hongkong.com

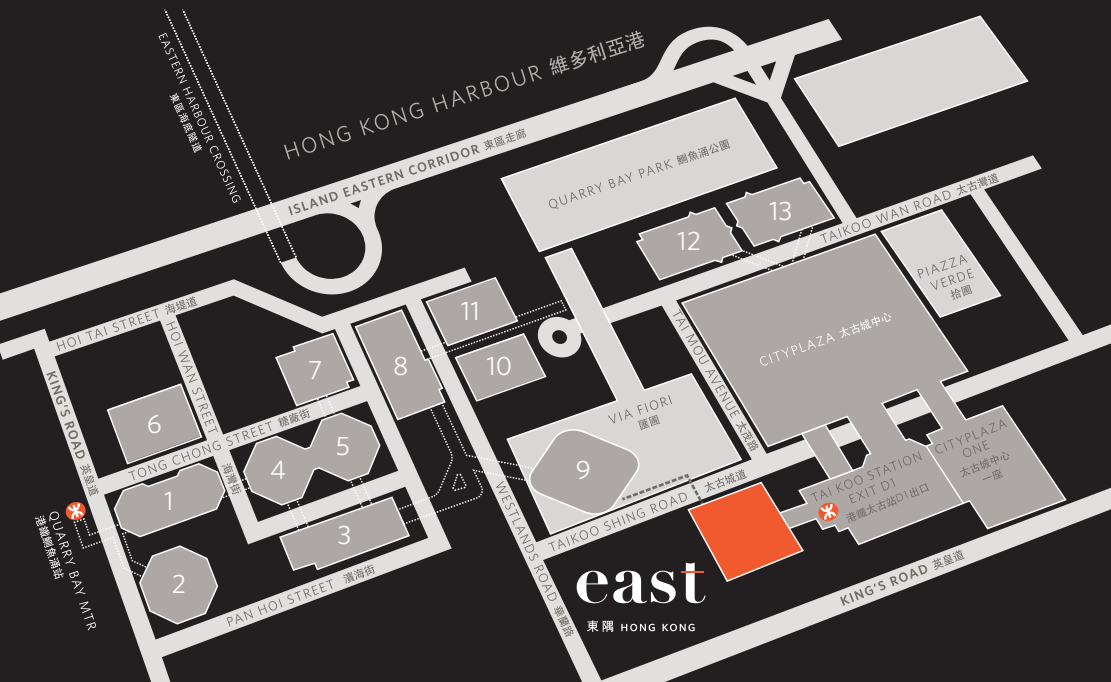

- | | | | |
|--------------------|-------------------|--------------------|--------------------|
| 1 DEVON HOUSE | 5 PCCW TOWER | 8 ONE TAIKOO PLACE | 12 CITYPLAZA THREE |
| 2 CAMBRIDGE HOUSE | 6 EAST RESIDENCES | 9 ONE ISLAND EAST | 13 CITYPLAZA FOUR |
| 3 TWO TAIKOO PLACE | | 10 OXFORD HOUSE | |
| 4 DORSET HOUSE | 7 LINCOLN HOUSE | 11 BERKSHIRE HOUSE | |

GDS code PH

Sabre 112871

Amadeus HKGEHH

Worldspan HKGEH

Apollo/Galileo 85274