

east

东隅 BEIJING

Urban Corner View

(370 sq ft / 35 sqm)

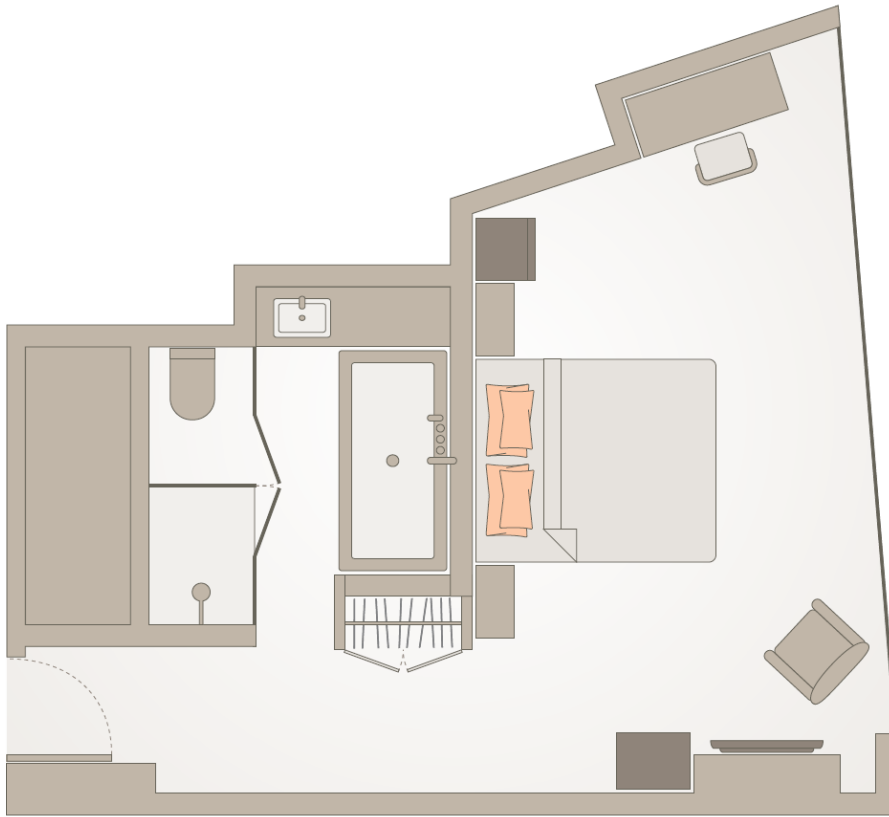

Guest Rooms and Suites

Urban Corner View rooms are available with Park or Urban view options and are complimented with floor-to-ceiling windows showcasing the panoramic views of Beijing. At 35 sqm (370 sqft) with a king-sized bed and the convenient facilities such as a work station, international power sockets and complimentary Wi-Fi, guests can make their own decision whether to go to the office or not and be just as productive. In addition to the walk-in rainfall shower, our Urban Corner Rooms also have a large soaking bathtub for when it's time to relax and unwind.

Room Features

- + King- sized bed
- + Comfortable down bedding
- + Walk-in rainfall shower and bathtub
- + Bathroom amenities by Hydro Basics
- + iPod dock and audio docking system
- + Complimentary Wi-Fi and wired broadband internet access
- + Complimentary coffee and tea
- + Hair-dryer
- + Iron and ironing board
- + Safety box
- + Flat screen TV
- + 24-hour room service
- + Multi-scene Lighting
- + Hardwood floors
- + Blackout blinds with sheer curtains

EAST, Beijing 北京东隅

No. 22 Jiuxianqiao Road,
Chaoyang District, Beijing, 100016
北京市朝阳区酒仙桥路22号

T +8610 8426 0888
www.east-beijing.com